

**LAY OUT**

- Proposed open stalls at  
ingate entrance left side
- open stall ① size: 10'-00" x 8'-00"
- open stall ② size: 20'-00" x 25'-00"

**REFERENCE**

TOTAL LAND AREA (B/D 88-S)	: 4.13 + 3.40 AC
LAND AREA OF BUS DEPOT	: 4.13 AC
LAND AREA OF BUS STATION	: 2.74 AC
AREA OCCUPIED BY DOT SHOPS & OTHER STRUCTURES	: 0.10 AC
VACANT LAND	: 0.56 AC

**NEW BUS DEPOT & BUS STATION AT KOTHAGUDEM - KHAMMAM DIST.**

APSRTC  
BUS STATION  
CHANDRUGONDA  
KMM DT.

Extent : 0.24 g<sup>5</sup> 2/4  
0.10 g<sup>5</sup> 5/4  
0.34 g<sup>5</sup> 7/4

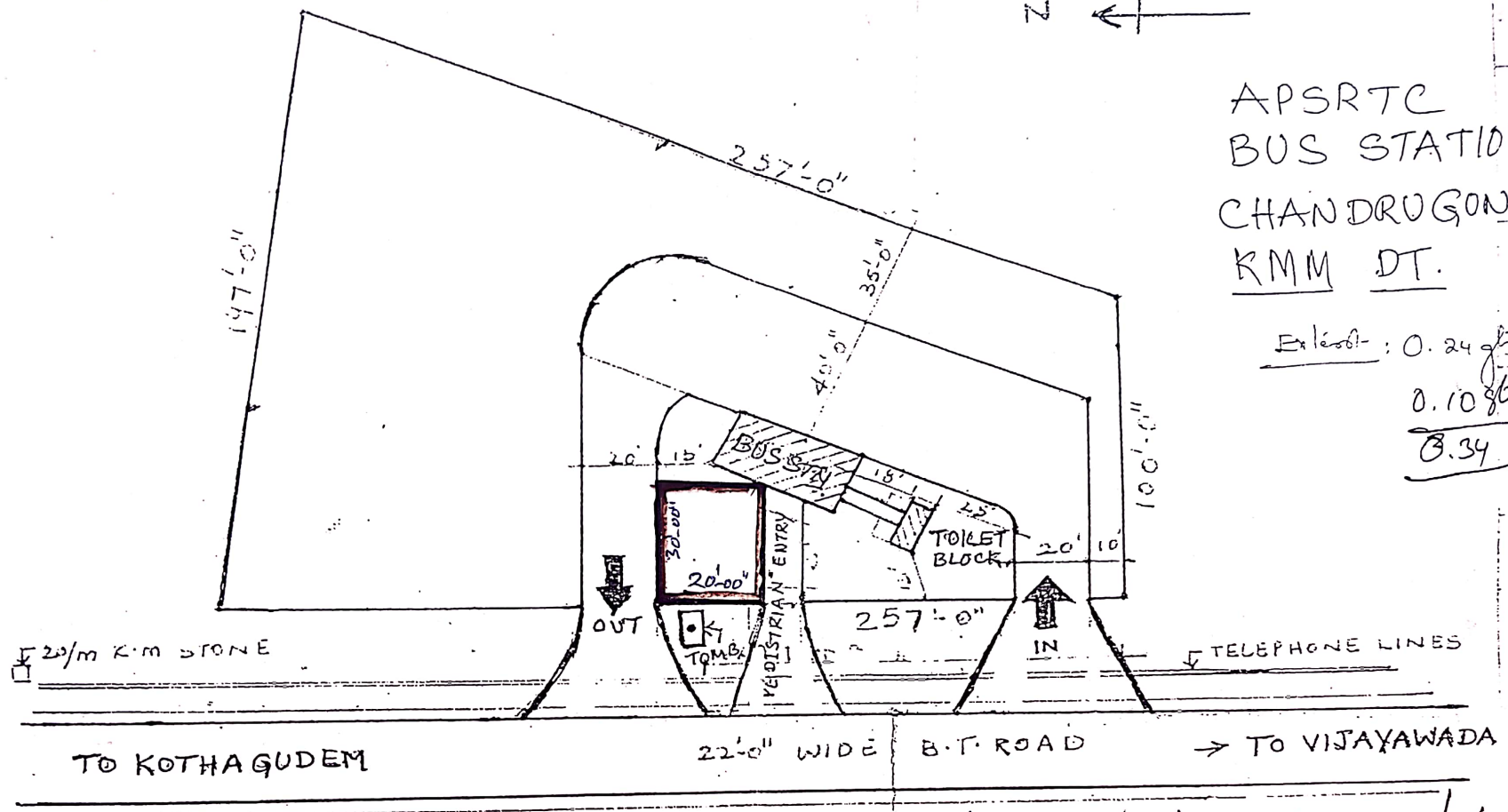

■ Proposed to canteen in size of 20' x 30'

LAY OUT  
SCALE : 1" = 50'-0"